



BLACK MARLIN

PLIF CAGE SYSTEM



SYSTEM OVERVIEW

4CIS Black Marlin Posterior Lumbar Interbody Fusion System (PLIF) consists of implants with various width, height and length to accommodate individual patient anatomy and graft material size. All components are manufactured from Medical Grade PEEK (polyetheretherketone) and Titanium. All products are supplied "NON-STERILE".

Product highlight

- Large graft area provides generous biological coverage
- Convex and Lordotic (Available in 0°, 4° & 8°) Series
- Bulleted nose helps facilitate insertion

Lordotic

- Length : 22 & 25 mm
20, 28, 32, 36 mm (Optional)
- Width : 10 mm
- Lordosis : 0 degree, 4 degree & 8 degree
- Material : PEEK and Titanium

Convex

- Length : 22 & 25 mm
20, 28, 32, 36 mm (Optional)
- Width : 10 mm
- Material : PEEK and Titanium

Convex



Lordotic



0°

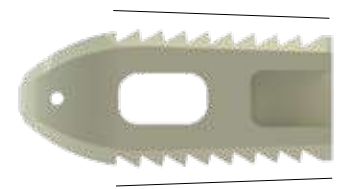

4°

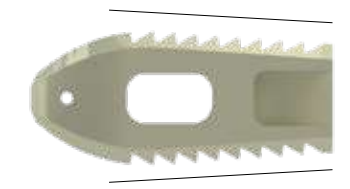

8°

PEEK IMPLANTS



0° angle

Heights	10 x 20 mm	10 x 22 mm	10 x 25 mm	10 x 28 mm	10 x 32 mm	10 x 36 mm
	Optional			Optional	Optional	Optional
8 mm	1653 - 2008	1653 - 2208	1653 - 2508	1653 - 2808	1653 - 3208	1653 - 3608
9 mm	1653 - 2009	1653 - 2209	1653 - 2509	1653 - 2809	1653 - 3209	1653 - 3609
10 mm	1653 - 2010	1653 - 2210	1653 - 2510	1653 - 2810	1653 - 3210	1653 - 3610
11 mm	1653 - 2011	1653 - 2211	1653 - 2511	1653 - 2811	1653 - 3211	1653 - 3611
12 mm	1653 - 2012	1653 - 2212	1653 - 2512	1653 - 2812	1653 - 3212	1653 - 3612
13 mm	1653 - 2013	1653 - 2213	1653 - 2513	1653 - 2813	1653 - 3213	1653 - 3613
14 mm	1653 - 2014	1653 - 2214	1653 - 2514	1653 - 2814	1653 - 3214	1653 - 3614
15 mm	1653 - 2015	1653 - 2215	1653 - 2515	1653 - 2815	1653 - 3215	1653 - 3615
16 mm	1653 - 2016	1653 - 2216	1653 - 2516	1653 - 2816	1653 - 3216	1653 - 3616

4° angle

Heights	10 x 20 mm	10 x 22 mm	10 x 25 mm	10 x 28 mm	10 x 32 mm	10 x 36 mm
	Optional			Optional	Optional	Optional
8 mm	1654 - 2008	1654 - 2208	1654 - 2508	-	-	-
9 mm	1654 - 2009	1654 - 2209	1654 - 2509	1654 - 2809	1654 - 3209	1654 - 3609
10 mm	1654 - 2010	1654 - 2210	1654 - 2510	1654 - 2810	1654 - 3210	1654 - 3610
11 mm	1654 - 2011	1654 - 2211	1654 - 2511	1654 - 2811	1654 - 3211	1654 - 3611
12 mm	1654 - 2012	1654 - 2212	1654 - 2512	1654 - 2812	1654 - 3212	1654 - 3612
13 mm	1654 - 2013	1654 - 2213	1654 - 2513	1654 - 2813	1654 - 3213	1654 - 3613
14 mm	1654 - 2014	1654 - 2214	1654 - 2514	1654 - 2814	1654 - 3214	1654 - 3614
15 mm	1654 - 2015	1654 - 2215	1654 - 2515	1654 - 2815	1654 - 3215	1654 - 3615
16 mm	1654 - 2016	1654 - 2216	1654 - 2516	1654 - 2816	1654 - 3216	1654 - 3616

8° angle

Heights	10 x 20 mm	10 x 22 mm	10 x 25 mm	10 x 28 mm	10 x 32 mm	10 x 36 mm
	Optional			Optional	Optional	Optional
9 mm	1655 - 2009	1655 - 2209	1655 - 2509	-	-	-
10 mm	1655 - 2010	1655 - 2210	1655 - 2510	1655 - 2810	1655 - 3210	1655 - 3610
11 mm	1655 - 2011	1655 - 2211	1655 - 2511	1655 - 2811	1655 - 3211	1655 - 3611
12 mm	1655 - 2012	1655 - 2212	1655 - 2512	1655 - 2812	1655 - 3212	1655 - 3612
13 mm	1655 - 2013	1655 - 2213	1655 - 2513	1655 - 2813	1655 - 3213	1655 - 3613
14 mm	1655 - 2014	1655 - 2214	1655 - 2514	1655 - 2814	1655 - 3214	1655 - 3614
15 mm	1655 - 2015	1655 - 2215	1655 - 2515	1655 - 2815	1655 - 3215	1655 - 3615
16 mm	1655 - 2016	1655 - 2216	1655 - 2516	1655 - 2816	1655 - 3216	1655 - 3616

Convex

Heights	10 x 20 mm	10 x 22 mm	10 x 25 mm	10 x 28 mm	10 x 32 mm	10 x 36 mm
	Optional			Optional	Optional	Optional
8 mm	1652 - 2008	1652 - 2208	1652 - 2508	1652 - 2808	1652 - 3208	1652 - 3608
9 mm	1652 - 2009	1652 - 2209	1652 - 2509	1652 - 2809	1652 - 3209	1652 - 3609
10 mm	1652 - 2010	1652 - 2210	1652 - 2510	1652 - 2810	1652 - 3210	1652 - 3610
11 mm	1652 - 2011	1652 - 2211	1652 - 2511	1652 - 2811	1652 - 3211	1652 - 3611
12 mm	1652 - 2012	1652 - 2212	1652 - 2512	1652 - 2812	1652 - 3212	1652 - 3612
13 mm	1652 - 2013	1652 - 2213	1652 - 2513	1652 - 2813	1652 - 3213	1652 - 3613
14 mm	1652 - 2014	1652 - 2214	1652 - 2514	1652 - 2814	1652 - 3214	1652 - 3614
15 mm	1652 - 2015	1652 - 2215	1652 - 2515	1652 - 2815	1652 - 3215	1652 - 3615
16 mm	1652 - 2016	1652 - 2216	1652 - 2516	1652 - 2816	1652 - 3216	1652 - 3616

TITANIUM IMPLANTS



0° angle

Heights	10 x 20 mm	10 x 22 mm	10 x 25 mm	10 x 28 mm	10 x 32 mm	10 x 36 mm
	Optional			Optional	Optional	Optional
8 mm	2016 - 2008	2016 - 2208	2016 - 2508	2016 - 2808	2016 - 3208	2016 - 3608
9 mm	2016 - 2009	2016 - 2209	2016 - 2509	2016 - 2809	2016 - 3209	2016 - 3609
10 mm	2016 - 2010	2016 - 2210	2016 - 2510	2016 - 2810	2016 - 3210	2016 - 3610
11 mm	2016 - 2011	2016 - 2211	2016 - 2511	2016 - 2811	2016 - 3211	2016 - 3611
12 mm	2016 - 2012	2016 - 2212	2016 - 2512	2016 - 2812	2016 - 3212	2016 - 3612
13 mm	2016 - 2013	2016 - 2213	2016 - 2513	2016 - 2813	2016 - 3213	2016 - 3613
14 mm	2016 - 2014	2016 - 2214	2016 - 2514	2016 - 2814	2016 - 3214	2016 - 3614
15 mm	2016 - 2015	2016 - 2215	2016 - 2515	2016 - 2815	2016 - 3215	2016 - 3615
16 mm	2016 - 2016	2016 - 2216	2016 - 2516	2016 - 2816	2016 - 3216	2016 - 3616

4° angle

Heights	10 x 20 mm	10 x 22 mm	10 x 25 mm	10 x 28 mm	10 x 32 mm	10 x 36 mm
	Optional			Optional	Optional	Optional
8 mm	2017 - 2008	2017 - 2208	2017 - 2508	-	-	-
9 mm	2017 - 2009	2017 - 2209	2017 - 2509	2017 - 2809	2017 - 3209	2017 - 3609
10 mm	2017 - 2010	2017 - 2210	2017 - 2510	2017 - 2810	2017 - 3210	2017 - 3610
11 mm	2017 - 2011	2017 - 2211	2017 - 2511	2017 - 2811	2017 - 3211	2017 - 3611
12 mm	2017 - 2012	2017 - 2212	2017 - 2512	2017 - 2812	2017 - 3212	2017 - 3612
13 mm	2017 - 2013	2017 - 2213	2017 - 2513	2017 - 2813	2017 - 3213	2017 - 3613
14 mm	2017 - 2014	2017 - 2214	2017 - 2514	2017 - 2814	2017 - 3214	2017 - 3614
15 mm	2017 - 2015	2017 - 2215	2017 - 2515	2017 - 2815	2017 - 3215	2017 - 3615
16 mm	2017 - 2016	2017 - 2216	2017 - 2516	2017 - 2816	2017 - 3216	2017 - 3616

8° angle

Heights	10 x 20 mm	10 x 22 mm	10 x 25 mm	10 x 28 mm	10 x 32 mm	10 x 36 mm
	Optional			Optional	Optional	Optional
9 mm	2018 - 2009	2018 - 2209	2018 - 2509	-	-	-
10 mm	2018 - 2010	2018 - 2210	2018 - 2510	2018 - 2810	2018 - 3210	2018 - 3610
11 mm	2018 - 2011	2018 - 2211	2018 - 2511	2018 - 2811	2018 - 3211	2018 - 3611
12 mm	2018 - 2012	2018 - 2212	2018 - 2512	2018 - 2812	2018 - 3212	2018 - 3612
13 mm	2018 - 2013	2018 - 2213	2018 - 2513	2018 - 2813	2018 - 3213	2018 - 3613
14 mm	2018 - 2014	2018 - 2214	2018 - 2514	2018 - 2814	2018 - 3214	2018 - 3614
15 mm	2018 - 2015	2018 - 2215	2018 - 2515	2018 - 2815	2018 - 3215	2018 - 3615
16 mm	2018 - 2016	2018 - 2216	2018 - 2516	2018 - 2816	2018 - 3216	2018 - 3616

Convex

Heights	10 x 20 mm	10 x 22 mm	10 x 25 mm	10 x 28 mm	10 x 32 mm	10 x 36 mm
	Optional			Optional	Optional	Optional
8 mm	2015 - 2008	2015 - 2208	2015 - 2508	2015 - 2808	2015 - 3208	2015 - 3608
9 mm	2015 - 2009	2015 - 2209	2015 - 2509	2015 - 2809	2015 - 3209	2015 - 3609
10 mm	2015 - 2010	2015 - 2210	2015 - 2510	2015 - 2810	2015 - 3210	2015 - 3610
11 mm	2015 - 2011	2015 - 2211	2015 - 2511	2015 - 2811	2015 - 3211	2015 - 3611
12 mm	2015 - 2012	2015 - 2212	2015 - 2512	2015 - 2812	2015 - 3212	2015 - 3612
13 mm	2015 - 2013	2015 - 2213	2015 - 2513	2015 - 2813	2015 - 3213	2015 - 3613
14 mm	2015 - 2014	2015 - 2214	2015 - 2514	2015 - 2814	2015 - 3214	2015 - 3614
15 mm	2015 - 2015	2015 - 2215	2015 - 2515	2015 - 2815	2015 - 3215	2015 - 3615
16 mm	2015 - 2016	2015 - 2216	2015 - 2516	2015 - 2816	2015 - 3216	2015 - 3616

INSTRUMENTS

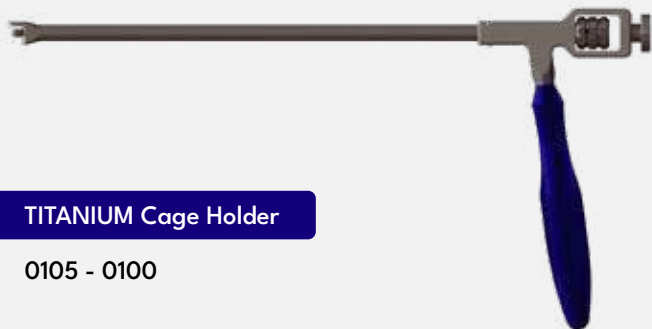

TITANIUM Cage Holder

0105 - 0100

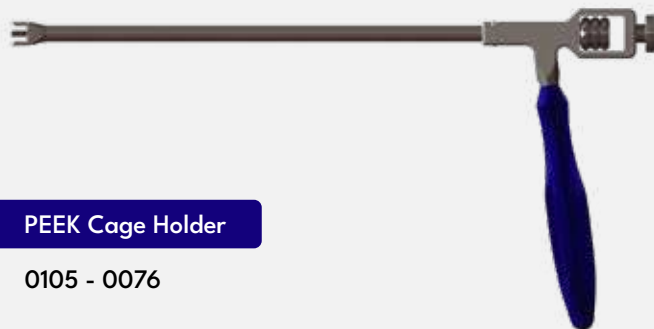

PEEK Cage Holder

0105 - 0076

Trial



0° angle

Heights	10 x 20 mm	10 x 22 mm	10 x 25 mm	10 x 28 mm	10 x 32 mm	10 x 36 mm
8 mm	0105 - 0501	0105 - 0512	0105 - 0523	0105 - 0534	0105 - 0545	0105 - 0556
9 mm	0105 - 0502	0105 - 0513	0105 - 0524	0105 - 0535	0105 - 0546	0105 - 0557
10 mm	0105 - 0503	0105 - 0514	0105 - 0525	0105 - 0536	0105 - 0547	0105 - 0558
11 mm	0105 - 0504	0105 - 0515	0105 - 0526	0105 - 0537	0105 - 0548	0105 - 0559
12 mm	0105 - 0505	0105 - 0516	0105 - 0527	0105 - 0538	0105 - 0549	0105 - 0560
13 mm	0105 - 0506	0105 - 0517	0105 - 0528	0105 - 0539	0105 - 0550	0105 - 0561
14 mm	0105 - 0507	0105 - 0518	0105 - 0529	0105 - 0540	0105 - 0551	0105 - 0562
15 mm	0105 - 0508	0105 - 0519	0105 - 0530	0105 - 0541	0105 - 0552	0105 - 0563
16 mm	0105 - 0509	0105 - 0520	0105 - 0531	0105 - 0542	0105 - 0553	0105 - 0564
17 mm	0105 - 0510	0105 - 0521	0105 - 0532	0105 - 0543	0105 - 0554	0105 - 0565
18 mm	0105 - 0511	0105 - 0522	0105 - 0533	0105 - 0544	0105 - 0555	0105 - 0566

4° angle

Heights	10 x 20 mm	10 x 22 mm	10 x 25 mm	10 x 28 mm	10 x 32 mm	10 x 36 mm
8 mm	0105 - 0567	0105 - 0578	0105 - 0589	0105 - 0600	0105 - 0611	0105 - 0622
9 mm	0105 - 0568	0105 - 0579	0105 - 0590	0105 - 0601	0105 - 0612	0105 - 0623
10 mm	0105 - 0569	0105 - 0580	0105 - 0591	0105 - 0602	0105 - 0613	0105 - 0624
11 mm	0105 - 0570	0105 - 0581	0105 - 0592	0105 - 0603	0105 - 0614	0105 - 0625
12 mm	0105 - 0571	0105 - 0582	0105 - 0593	0105 - 0604	0105 - 0615	0105 - 0626
13 mm	0105 - 0572	0105 - 0583	0105 - 0594	0105 - 0605	0105 - 0616	0105 - 0627

14 mm	0105 - 0573	0105 - 0584	0105 - 0595	0105 - 0606	0105 - 0617	0105 - 0628
15 mm	0105 - 0574	0105 - 0585	0105 - 0596	0105 - 0607	0105 - 0618	0105 - 0629
16 mm	0105 - 0575	0105 - 0586	0105 - 0597	0105 - 0608	0105 - 0619	0105 - 0630
17 mm	0105 - 0576	0105 - 0587	0105 - 0598	0105 - 0609	0105 - 0620	0105 - 0631
18 mm	0105 - 0577	0105 - 0588	0105 - 0599	0105 - 0610	0105 - 0621	0105 - 0632

8° angle

Heights	10 x 20 mm	10 x 22 mm	10 x 25 mm	10 x 28 mm	10 x 32 mm	10 x 36 mm
8 mm	0105 - 0633	0105 - 0644	0105 - 0655	0105 - 0666	0105 - 0677	0105 - 0688
9 mm	0105 - 0634	0105 - 0645	0105 - 0656	0105 - 0667	0105 - 0678	0105 - 0689
10 mm	0105 - 0635	0105 - 0646	0105 - 0657	0105 - 0668	0105 - 0679	0105 - 0690
11 mm	0105 - 0636	0105 - 0647	0105 - 0658	0105 - 0669	0105 - 0680	0105 - 0691
12 mm	0105 - 0637	0105 - 0648	0105 - 0659	0105 - 0670	0105 - 0681	0105 - 0692
13 mm	0105 - 0638	0105 - 0649	0105 - 0660	0105 - 0671	0105 - 0682	0105 - 0693
14 mm	0105 - 0639	0105 - 0650	0105 - 0661	0105 - 0672	0105 - 0683	0105 - 0694
15 mm	0105 - 0640	0105 - 0651	0105 - 0662	0105 - 0673	0105 - 0684	0105 - 0695
16 mm	0105 - 0641	0105 - 0652	0105 - 0663	0105 - 0674	0105 - 0685	0105 - 0696
17 mm	0105 - 0642	0105 - 0653	0105 - 0664	0105 - 0675	0105 - 0686	0105 - 0697
18 mm	0105 - 0643	0105 - 0654	0105 - 0665	0105 - 0676	0105 - 0687	0105 - 0698

Convex

Heights	10 x 20 mm	10 x 22 mm	10 x 25 mm	10 x 28 mm	10 x 32 mm	10 x 36 mm
8 mm	0105 - 0699	0105 - 0710	0105 - 0721	0105 - 0732	0105 - 0743	0105 - 0754
9 mm	0105 - 0700	0105 - 0711	0105 - 0722	0105 - 0733	0105 - 0744	0105 - 0755
10 mm	0105 - 0701	0105 - 0712	0105 - 0723	0105 - 0734	0105 - 0745	0105 - 0756
11 mm	0105 - 0702	0105 - 0713	0105 - 0724	0105 - 0735	0105 - 0746	0105 - 0757
12 mm	0105 - 0703	0105 - 0714	0105 - 0725	0105 - 0736	0105 - 0747	0105 - 0758
13 mm	0105 - 0704	0105 - 0715	0105 - 0726	0105 - 0737	0105 - 0748	0105 - 0759
14 mm	0105 - 0705	0105 - 0716	0105 - 0727	0105 - 0738	0105 - 0749	0105 - 0760
15 mm	0105 - 0706	0105 - 0717	0105 - 0728	0105 - 0739	0105 - 0750	0105 - 0761
16 mm	0105 - 0707	0105 - 0718	0105 - 0729	0105 - 0740	0105 - 0751	0105 - 0762
17 mm	0105 - 0708	0105 - 0719	0105 - 0730	0105 - 0741	0105 - 0752	0105 - 0763
18 mm	0105 - 0709	0105 - 0720	0105 - 0731	0105 - 0742	0105 - 0753	0105 - 0764



Sharp Reamer

Ø7.0 mm 0105 - 0105

Ø8.0 mm 0105 - 0106

Ø9.0 mm 0105 - 0107

Ø10.0 mm 0105 - 0108

Ø11.0 mm 0105 - 0109

Ø12.0 mm 0105 - 0110

Ø13.0 mm 0105 - 0111

Ø14.0 mm 0105 - 0112



Blunt Reamer

Ø7.0 mm 0105 - 0123

Ø8.0 mm 0105 - 0124

Ø9.0 mm 0105 - 0125

Ø10.0 mm 0105 - 0126

Ø11.0 mm 0105 - 0127

Ø12.0 mm 0105 - 0128

Ø13.0 mm 0105 - 0129

Ø14.0 mm 0105 - 0130



T - Handle

0105-0220



Small Cup Currete, Right

0105 - 0233



Small Cup Currete, Left

0105 - 0234



Small Cup Currete, Straight

0105 - 0232



Osteotome, Right

0105 - 0230



Osteotome, Left

0105 - 0131



Funnel

0105 - 0215



Funnel Impactor

0105 - 0136



Slide Hammer

0105 - 0080



OPTIONAL INSTRUMENTS

Angle Rasp, Dual Sided

0105 - 0208



Rasp, Dual Sided

0105 - 0205



Ring Curette

0105 - 0207



Box Curette, Left

0105 - 0134



Box Curette, Right

0105 - 0205



Box Curette, Stright

0105 - 0207



Graft Holder

0105-0135

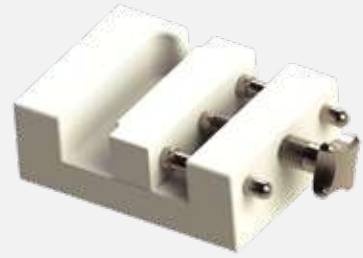
**Graft Impactor**

0105-0134

**Cage Impactor**

0105-0133

**Implant Caddy**

0105 - 0133

0° angle

4° angle

8° angle

Convex

**Instrument Container**

0105 - 0133





 www.solco.co.in |  sales@solco.co.in

Corporate Office

5 & 6, 3rd Floor, B.Jadav Chambers, Above Sales India,
Ashram Road, Ahmedabad-380009, India.

Plant

Survey No. 1540, Village-Rajpur, B/s. Torrent Pharma,
Ahmedabad-Mehsana Highway, Tal. Kadi,
Dist. Mehsana-382715, Gujarat, India.